



HYDE NEW HOMES AT

BRAMBLE PARK

WEST SUSSEX BN6 9LP



Jill Windmill, Clayton Park



Brighton



Local golf courses

Community spirit in a country setting

Bramble Park is a select development in the traditional West Sussex village of Hurstpierpoint, surrounded by glorious South Downs countryside. We are offering a choice of high-quality, affordable homes under the Shared Ownership Scheme.

The beauty of Bramble Park is the winning combination of country living with convenient access to shops and other amenities. A short stroll and you are in open countryside, yet also within easy walking distance is the village centre, which has a good selection of shops, restaurants, cafés and pubs.

For a wider choice of shops and other facilities, it's just four miles to lively Burgess Hill. Recently designated a Fairtrade Town, it has a wide range of famous-name and independent stores, many of which are conveniently located in the Market Place and Martlets shopping centres with plenty of parking close by. The regular farmers' market is great for fresh meat and produce, and the town also has a two-screen cinema and eateries for all tastes.

The well-respected St Lawrence C of E Primary School is just over a mile from the development and many other good schools in the area include The Burgess Hill Academy for secondary level education.

Trains run regularly to London and Brighton from nearby Hassocks station. For drivers, the A23 is easily accessible, connecting with the M23 for Gatwick Airport and the M25.



A selection of restaurants and pubs within the area



Shopping in Burgess Hill 11 mins (4.7 miles) & Brighton 22 mins (10.4 miles)



Excellent local schools and library



Hassocks to London Bridge / Victoria, 1 hour approx



Hassock railway station 10 mins. (2.2 miles)



Bus services to Hassocks, Burgess Hill & Brighton.

Source: Google Maps and National Rail Enquiries www.traveline.info



Hyde New Homes



Contact us now

Call: **0345 606 1221**

Email: **info@hydenewhomes.co.uk**

Visit: **www.hydenewhomes.co.uk**

TWO BEDROOM HOUSE

Plot 71 as shown, plot 8 is handed.

KITCHEN

- Symphony fitted kitchen
- Laminate worktop with upstands
- Hotpoint chimney extractor hood
- Hotpoint stainless steel single oven
- Hotpoint 4 burner gas hob
- Vinyl flooring
- Space and service connections for washing machine and fridge freezer
- Down lighters

BATHROOM

- White chinaware
- Vinyl flooring
- Porcelanosa tiling
- Down lighters
- Shaver socket
- Bath/shower screen
- Towel rail

GENERAL

- Carpet fitted throughout
- White Dulux matt emulsion walls, satin to kitchen & bathroom
- Terrestrial TV/FM Sky+ cables in loft for connectivity by chosen installer
- BT fibre optic home hub
- Combi boiler
- Double glazed white PVCu windows
- Rotary drier
- Water Butt
- External water tap
- Fully turfed front and rear garden

GROUND FLOOR

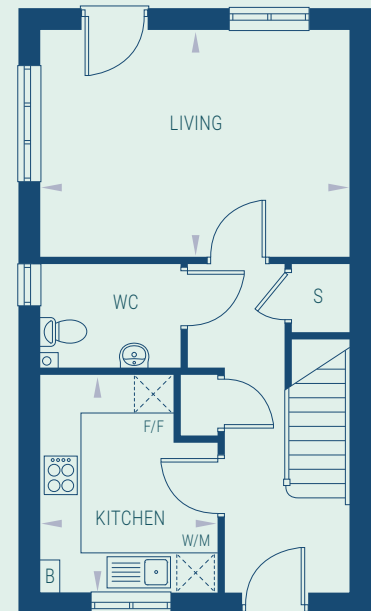

FIRST FLOOR

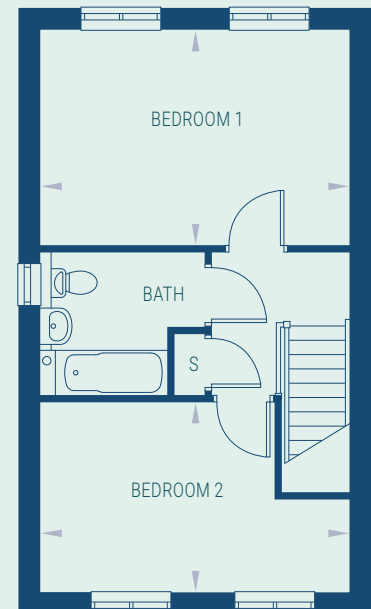

KEY

S Storage B Boiler

F/F Space for fridge freezer

W/M Space for washing machine

INTERNAL DIMENSIONS

Living	4.70 x 3.46m	15' 5" x 11' 4"
Kitchen	2.72 x 3.33m	8' 11" x 10' 11"
Bedroom 1	4.70 x 3.28m	15' 5" x 10' 9"
Bedroom 2	4.70 x 2.89m	15' 5" x 9' 6"
TOTAL	80.32 m²	865 ft²

Note: Some plots are mirrored. Please refer to individual floorplans. Floorplans are not to scale and are indicative only. Location of windows, doors, kitchen units and appliances, and bathroom fittings may differ. Doors may swing in the opposite direction to that shown on selected units. Windows may open differently or be fixed. All measurements have been prepared from preliminary plans and are intended to give a general indication of the proposed development and the size and layout of individual plots. Measurements shown are maximum room measurements. Total areas shown are maximum and may vary for each unit within a type. All dimensions are quoted in conformity with RICS (GIA EIFA) code of measuring practice (6th edition).

SITE PLAN



KEY: SITE PLAN

- Hyde New Homes Shared Ownership homes
- Hyde New Homes Affordable Rent homes
- Private Sale homes
- 6 Plot numbers





HYDE NEW HOMES AT

BRAMBLE PARK

WEST SUSSEX BN6 9LP



Hyde
New Homes



Contact us now

Call: **0345 606 1221**

Email: **info@hydenewhomes.co.uk**

Visit: **www.hydenewhomes.co.uk**